

# 36026 V5J

## 100 lb. (45 kg) Capacity Rigid-Mount Washer-Extractor Specification Sheet



[milnor.com](http://milnor.com)



### STANDARD FEATURES:

- RinSave® water saving technology
- 7 speeds (2 wash, 1 distribution, 1 RinSave, 3 extract)
- E-P Plus® programmable controller
- Single-motor inverter drive
- Tall, lifting ribs
- Tapered roller bearings
- High M.A.F. (Mechanical Action Factor)
- Large cylinder perforations
- Fresh-water flushing chemical manifold
- Auto tension V-belt drive
- Six (6) liquid chemical injection ports
- Control is configurable to display language of choice
- 5-year limited warranty on frame, cylinder & shell



### OPTIONAL FEATURES:

- Steam
- Electric heat
- 5 compartment flushing supply injector
- Prison package

## Why Purchase Milnor?

**BENEFIT: Saves water, energy and time.** RinSave® water saver in conjunction with large cylinder perforations provides more efficient rinsing.

**BENEFIT: Saves labor.** Larger cylinder volume than most competitive, similar-sized washer-extractors provides greater productivity. More linen washed per day, or fewer hours required to process.

**BENEFIT: Saves linen replacement costs.** Faster process times reduce fabric wear, promoting longer linen life!

**BENEFIT: Greater mechanical action (M.A.F.) leads to better wash quality.**

Greater cylinder perforated area, tall rib construction and precise cylinder speeds generate better cleaning results, better rinsing, and better extraction.

**BENEFIT: Better extraction saves dryer fuel.** High extract provides excellent moisture removal. Lower extract speeds are available for uniforms, delicate textiles and blended fabrics.

**BENEFIT: Fewer operator errors.** E-P Plus® controller with back-lit LCD display allows operators to choose formulas from real words, not codes. Standard controller features English/Spanish (other languages optional). Controller also provides diagnostic and error messages, shortening training time of new employees.

**BENEFIT: Faster repairs mean less downtime.** Superior product support through local, highly-skilled dealers.



Superior cylinder design



Safe chemical injection



Solid industrial frame

Contact Milnor for your local, authorized dealer:

**PELLERIN MILNOR CORPORATION**

P.O. Box 400, Kenner, LA 70063 • t: 504-467-9591 • [milnorinfo@milnor.com](mailto:milnorinfo@milnor.com)

# 36026 V5J

## 100 lb. (45 kg) Capacity Rigid-Mount Washer-Extractor Specification Sheet



[milnor.com](http://milnor.com)

### LEGEND

|           |   |
|-----------|---|
| <b>C</b>  | Cold water inlet, .75" (19 mm) NPT          |
| <b>D</b>  | Drain to rear, 3" (76 mm) pipe socket joint |
| <b>E</b>  | Electrical connection                       |
| <b>F</b>  | Foundation pads                             |
| <b>H</b>  | Hot water inlet, .75" (19 mm) NPT           |
| <b>L1</b> | Soap chute                                  |
| <b>L2</b> | Liquid supply inlets                        |

FRONT VIEW

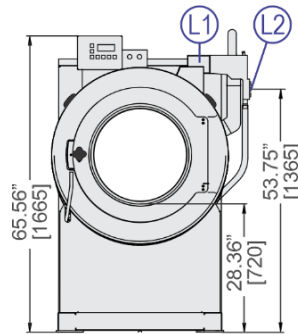

RIGHT VIEW

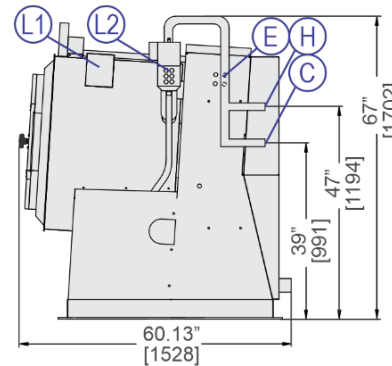

REAR VIEW

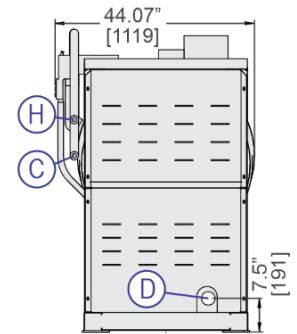

FOUNDATION VIEW

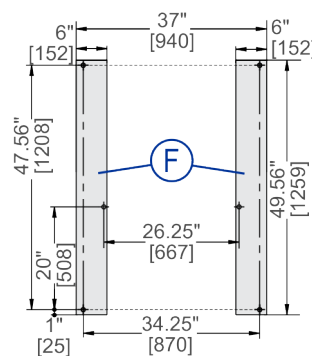

ANCHORING DETAIL

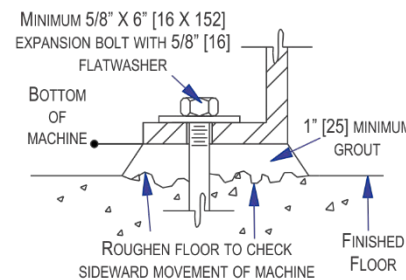

FLOOR REQUIREMENT 12" MINIMUM.

RECOMMENDED



### MECHANICAL SPECIFICATIONS

|  |   |
|--|---|
| Capacity – lb. (kg)                                      | 100 (45)                                |
| Cylinder Diameter x Depth – in. (mm)                     | 36 x 26 (914 x 660)                     |
| Cylinder Volume – cu. ft. (L)                            | 15.3 (434)                              |
| Door Opening – in. (mm)                                  | 21.69 (551)                             |
| Machine Dimensions (W x D x H) – in. (mm)                | 44.07 x 60.13 x 67 (1119 x 1528 x 1702) |
| Shipping Dimensions (W x D x H) – in. (mm)               | 75 x 60 x 73.5 (1905 x 1524 x 1867)     |
| Motor – HP (kW)  | 5 (3.72)                                |
| Wash Speed – RPM   | 25-45                                   |
| Distribution Speed – RPM                                 | 65                                      |
| Extraction Speed – RPM                                   | 200-541                                 |
| Extraction G-Force – for balanced loads                  | 150                                     |
| Static Weight – lb. (kg)♦                                | 2171 (985)                              |
| Max. Dynamic Load RMS – lb. (kg)♦                        | 2643 (1199)                             |
| Frequency - Hz♦  | 9.02                                    |
| Water Pressure <sup>(Required)</sup> – psi (bar)         | 10-75 (.68-5.1)                         |
| Water Valve - Cv Rating at 72°F (22°C)                   | 6.5 (25)                                |
| Minimum Recommended Distance Between Machines – in. (mm) | 12 (305)                                |

### ELECTRICAL SPECIFICATIONS

| Voltage       | Running Amps | Fuse (Amps) | Circuit Breaker (Amps) |
|---------------|--------------|-------------|------------------------|
| 220/3/50-60   | 9            | FRN20       | 20                     |
| 208, 240/3/60 | 10, 9        | FRN20       | 20                     |
| 380/3/50-60   | 5.7          | FRS15       | 15                     |
| 415/3/50      | 4.5          | FRS15       | 15                     |
| 480/3/60      | 4.5          | FRS15       | 15                     |

See Fuse and Wire Size manual MAEFUSE1BE for safety information. Contact factory regarding single phase availability.

▲ See dimensional drawing for complete details.

♦ It is the sole responsibility of the owner/user to assure that the floor and/ or any other supporting structure exceeds not only all applicable building codes, but also that the floor and/ or any other supporting structure for each washer-extractor or group of washer-extractors has sufficient strength and rigidity (i.e., a natural or resonant frequency many times greater than the rotational machine speed with a reasonable factory of safety) to support the weight of all the fully loaded machine(s) including the weight of the water and goods, and including the published 360° rotating sinusoidal RMS forces that are transmitted by the machine(s). Contact the factory for additional machine data for use by a structural engineer.

■ Machine bases made from concrete should either be part of a monolithic pour or should be tied into foundation and not isolated from existing floor.